

SHARE:



Join Our Email List



## The Messenger of St. Mark's | Lent | March 1, 2024

For your thought:

*He told those who were selling the doves, "Take these things out of here! Stop making my Father's house a marketplace!"*

--John 2:16



[Study this Sunday's Readings.](#)

### WORSHIP CORNER

Worship on Sunday is both in person and virtually, every week at 9:30 a.m. We live stream Sunday liturgies on our [Facebook](#) & [YouTube](#) channels.

Also, we offer a Midweek Eucharist every Thursday at 11 a.m. that is both in person and on our live-streaming platforms.

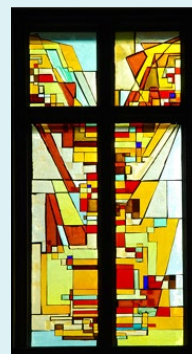

[View Sunday's Order of Worship](#)

[Click Here for All Offerings](#)

#### Useful links:

- [Fill out a form](#) to volunteer, donate altar flowers, fill out a new member/visitor form, and more!
- Access and/or edit your [Member Directory](#) information.
- To read or view [previous sermons, click here](#).

#### Important Upcoming Dates:

- **Tues. Mar. 5, 6:30 p.m., Music Makes Community**
- **Sun., Mar. 10, 9:30 a.m., All-Parish Meeting/Lunch/Discussion with the Architect #3 ([RSVP here](#))**
- **Sun., Mar. 10, 6:00 p.m., LGBTQ+ Worship & Potluck Dinner**
- **Sat., Mar. 16, 9:30 a.m. - 2:30 p.m., Lenten Quiet Day (Chapel)**
- **Sun., Mar. 24, 9:30 a.m., Palm Sunday**
- **Tues., June 4, 2024 Primary Election for NM residents**

### SAINT MARK'S MISSION, MINISTRY & OUTREACH

## All-Parish Meeting with the Architect #3 (with lunch provided)

### Architect Presentation Sunday, March 10 - Please RSVP!

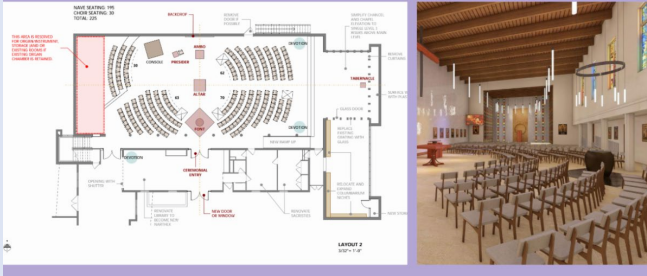

Please RSVP to the Third Congregational Meeting with the Architect, with a Catered Lunch on Sunday, March 10th from 9:30AM to 1PM. The Mediterranean-Style Lunch will be catered by Chello Grill.

[Please click here to RSVP!](#)

## “Sharing in Jesus’ Suffering” - A Lenten Quiet Day

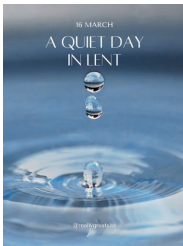

“Sharing in Jesus’ Suffering,” A Lenten Quiet Day at St. Mark’s, Saturday, March 16 from 9:30 a.m. to 2:30 p.m. in the Chapel. Lent and our Lord’s Passion are an invitation to us to share in his suffering through our own life-long pain and suffering so that we might also share in the new life of his resurrection.

On this quiet day morning we will engage in lectio Divina on the first part of the next day’s Gospel, John 12:20-26. For the afternoon we will experience one of Anthony DeMello’s exercises from his book *Sadhana: Christian Exercises in Eastern Form*, "The Sorrowful Mysteries."

The day will begin with coffee, tea, and goodies in the library at 9:30 a.m. beginning our morning session in the chapel at 10:00 a.m. The day will be mostly silent. We will reflect in small groups following the afternoon exercise and a time for silent personal reflection.

The Rev. Michael Jupin, spiritual director and contemplative prayer group leader will lead the day. **Bring a brown bag lunch (water, coffee, tea provided) and sign up on the table at the church entrance or register with Fr. Michael [via email here](#) or by phoning him at 505-295-3975. Please register by Wednesday night, March 13.**

## Lenten Lamentation Station



In this season of Lent, we acknowledge the ongoing reality of sin and suffering in our lives and in our world.

In this season, as we prepare to enter with Jesus into his suffering, we remember that Jesus has *already* entered into our suffering and the suffering of our whole world.

As we grieve the suffering of the earth and her children, and the suffering in our own lives, we pour out our prayers of lament to God.

**We invite you to add your own prayers of lamentation (both words and images) to the cross in the narthex at St. Mark's.**

## LGBTQ+ Ministry Event from the Diocese of the Rio Grande



Worship and Potluck Dinner at St. Mark’s Episcopal Church, [431 Richmond Place NE, Albuquerque 87106](#) During the liturgy, we will hear from young members of the LGBTQ+ community – issues they face and topics that are

important to them. This event is from the LGBTQ+ Ministry of the Episcopal Diocese of the Rio Grande.

### **Worship and Potluck Dinner**

Sunday, March 10, 2024, 6:00 pm

St. Mark's Episcopal Church

[431 Richmond PL NE, Albuquerque NM, 87106](#)

Also join us on [St. Mark's Facebook page](#).

For Questions, please contact Rev. David Martin at [LGBTQdrg@gmail.com](mailto:LGBTQdrg@gmail.com).

### **Upcoming Events for the LGBTQ+ Ministry:**

**Saturday, March 16, 1:00 p.m.**

**Pie Palooza at the Albuquerque Balloon Museum** This is a fundraiser for ORCA (Older Rainbow Community of Albuquerque). Contact [sc@orcaabq.org](mailto:sc@orcaabq.org) for ways to donate and participate.

**Saturday, April 20 - Save the Date!**

**Drag Queen Brunch and Bingo at St. Michael and All Angels Episcopal Church, 601 Montano Rd NW, Albuquerque 87107** Be sure to mark your calendars for this fun, first-time event with the LGBTQ+ Ministry of the Episcopal Diocese of the Rio Grande. Details will follow soon.

## **Music Makes Community**



Our next **ABQ MMC (Music that Makes Community) Song Circle** will be hosted by St. Mark's Episcopal Church on **Tuesday, March 5th**.

Music that Makes Community practices communal song-sharing that inspires deep spiritual connection, brave shared leadership, and sparks the possibility of transformation in our world.

We offer resources, training, and encouragement to individuals, organizations, and communities in the dynamic power of singing to connect others and ourselves.

ALL are welcome to come teach, share, learn, sing and/or listen to songs!

## **Voter Information Portal (NMVote.org)**



### **Upcoming Statewide Elections in New Mexico:**

- 2024 Primary Election: Tuesday, June 4, 2024
- 2024 General Election: Tuesday, November 5, 2024

It's always a good idea to check if your voter registration is still in the Secretary of State's database. For NM residents, please check your NM [voter registration status by clicking here](#).

If you have not registered to vote and are eligible, [please register online here](#) (For New Mexico residents only).

If you reside out of state, please visit <https://www.vote.org/> to find your state's voter registration information.

Voter Registration in New Mexico is available up to 28 days prior to an election, the closes (although there is [information on same day registration here](#)).

If you register to vote (in NM) after registration has closed, the county clerk will still accept your voter registration application, but it will not be processed until the thirty-five (35) days after the election.

There's a large swath of information regarding NM Elections. Please visit [NMVote.org](http://NMVote.org) for more NM voting/election information.

## Lenten Schedule 2024



[Click here for a printable version of the Lenten Schedule Card](#)

### GIVE TO ST. MARK'S



**Give by mail** (St. Mark's has a secure mailbox and is checked regularly). Send to: 431 Richmond Place NE, Albuquerque, NM 87106.



**Give electronically through [By PayPal®](#).**

**Please consider checking the box that reads, "I'd like to add to my donation to help offset the cost of processing."**



**Give electronically through the [Diocese of the Rio Grande Parish Donation site](#) and check the box next to "Albuquerque-St. Mark's".**

Just fill out the rest of the information and **click the Next button at the bottom of the page. Please make sure fill out "special instructions or comment" to let us know how to apply your gift** (e.g., pledge, congregational relief fund, etc.).

### DIOCESE & BEYOND

#### Mountain Top Eucharist (Tomorrow!)

**Directions to Capulin Spring Picnic Site:**

From I-40 and Exit 175, drive toward Cedar Crest on N-14. Follow N-14 aka the Turquoise Trail, for approximately 6.5 miles, to NM 536 aka the Sandia Crest Scenic Byway. Drive 8 miles up NM 536. Look for signs on your right. Capulin is located about 2 miles past the Sandia Peak Ski area.

**[For more information, please click here.](#)**



# Mountain Top Eucharist

**March 2:** Mountaintop Eucharist meet at Capulin Spring Picnic Site **11:30am**

**12 noon** Eucharist

**12:30 pm** Light Lunch

**1pm** optional: Stay and hike to summit (.6 miles), or bring a sled in case there is snow, or take the main trail to check out the ruins of an old mining shack, or do some bird watching and enjoy the surrounding beauty

## Video Updates from Bishop Michael Hunn of the DRG



Check out two Video Updates from Bishop Michael Hunn:

1. Feb 23, 2024 - [Annunciation House and the Diocese of the Rio Grande - YouTube](#) (asylum seeker)
2. Feb 24, 2024 - [The Hungry Gap and Lent - YouTube](#) (Bp. Hunn's 2024 Lenten Message)

## Please Pray for Presiding Bishop Michael Curry

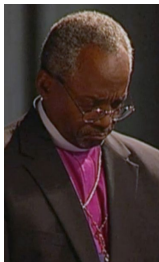

Presiding Bishop Michael Curry to receive pacemaker to treat irregular heartbeat (From Episcopal News Service)

The presiding bishop's atrial fibrillation was previously diagnosed during an annual physical exam. Surgery to insert a pacemaker is scheduled for March 1.

[For more details, please see the full article here.](#)

All are welcome to join us for worship during our Thursday 11 a.m. midweek Holy Eucharists and our Sunday Holy Eucharists at 9:30 a.m. You may join us in person or on Facebook & YouTube. Come as you are!



Email submissions should be sent ([via email](#)) to the Communications Specialist by 9:00 a.m. each Wednesday for inclusion on Thursday's e-news.

[www.stmarksabq.org](http://www.stmarksabq.org)

© 2024

St Mark's Episcopal Church | 431 Richmond Place NE, Albuquerque, NM 87106

[Unsubscribe communications@stmarksabq.org](mailto:Unsubscribe.communications@stmarksabq.org)

[Constant Contact Data Notice](#)

Sent by erin@stmarksabq.ccsend.com powered by



Try email marketing for free today!